

ENG Strain relief for lamp

Danger of electrocution!

Be sure to have a professional electrician complete installation. There is no warranty coverage for any halogen lamps and strain reliefs installed without observing European safety directives.

Caution!

Use HO3VVH2-F 2x 0.75 mm cable only for all connections.

Use only with low-pressure halogen lamps which comply with IEC 598 (EN 60598). The lamps must be permissible for use as exposed lamps.

The strain relief must fit the lamp used.

CE compliant with the applicable European directives.



Low-voltage strain relief (Figures 1 and 2):

Protection class 3 – Low voltage 12 V.

Use an isolating transformer complying with EN 61558, electronic step-down converter complying with EN 61347 or a voltage source complying with DIN VDE 0100, Part 410. Be sure to observe the instructions for installation of the device being used.



High-volt strain relief (Fig. 3):

Protection class 2 – High voltage 230 V.

The high-voltage strain relief must only be used with lamps designed for this purpose (see label on lamp).



Use high-voltage halogen lamps.

Installation

Danger of electrocution!

Disconnect voltage prior to installation. Ensure that voltage cannot be accidentally reconnected.

1. Insert strain relief in spring coil of lamp (see Fig. 1) or insert strain relief in rails and fix into place with screw (see Fig. 2 and Fig. 3).

1. Insert strain relief in spring coil of lamp (see Fig. 1) or insert strain relief in rails and fix into place with screw (see Fig. 2 and Fig. 3).

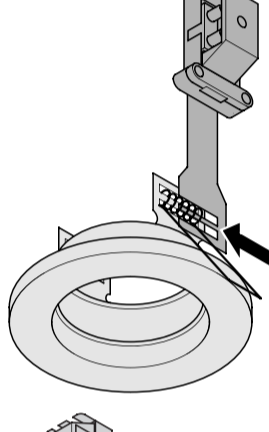

Fig. 1

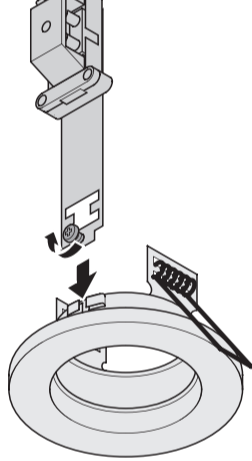

Fig. 2

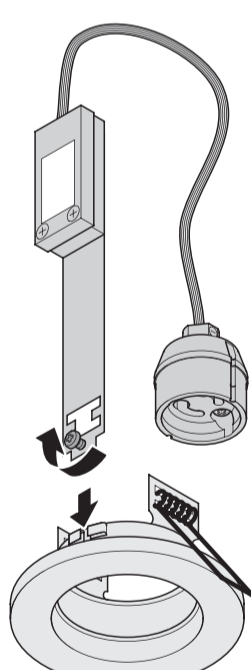

Fig. 3

2. Connect the strain relief.

High-voltage strain relief:

Connect the power cord to exposed contacts of the terminal. The socket is already connected to the appropriate contacts.

Low-voltage strain relief:

Install transformer based on the supplied instructions. Connect it on the input side of the 230 V cord and on the output side of the 12 V cord (see Figure 4).

Connect the socket and transformer to the terminal of the strain relief.

Do not shorten the cable on the socket!

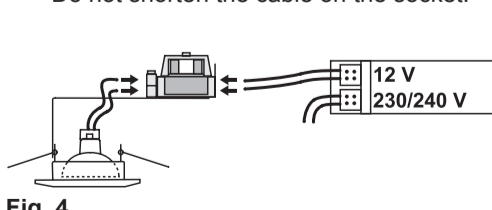

Fig. 4

(RU-05-07 / Edited by: ZINDEL AG, www.zindel.de)

rutec Licht GmbH & Co. KG

Carl-Zeiss-Str. 15

28857 Syke, Germany

PO Box 1437

28848 Syke, Germany



Phone: +49 (0) 42 42 95 65-0 E-mail: info@rutec.de

Fax: +49 (0) 42 42 95 65-25 http://www.rutec.de